



country properties  
village properties  
town homes  
barn conversions  
building plots

Woodland Avenue  
Colburn, Catterick Garrison, DL9 4WD

**Offers over £180,000**

**NICK & GORDON**  
**CARVER**  
RESIDENTIAL



\*\*\*Attention First Time Buyers\*\*\*

A surprisingly spacious property, with en-suite shower room off the double bedroom, ground floor cloakroom and a lovely dining kitchen, flooded with natural light.

The property opens into the entrance hall, leading off is the sitting room, kitchen diner, with double doors leading out to an enclosed rear garden, cloakroom and storage cupboard completes the accommodation on this floor.

To the first floor, the landing leads to two well proportioned double bedrooms, one with en-suite shower room, built in wardrobes, single bedroom and family bathroom with shower over bath.

Heading outside is an enclosed rear garden with a useful storage shed and two off-street parking spaces for vehicles to the front.

Early viewing recommended.





- Ideal First Time Buyers Property
- Cloakroom
- Enclosed Rear Garden
- Double Glazed Throughout
- Kitchen Diner
- En-suite Shower Room
- Off-Street Parking for Two Vehicles
- Viewing A Must

#### General Remarks

Tenure: Freehold

Services: Mains Gas, Electricity and Water

Council Tax: C



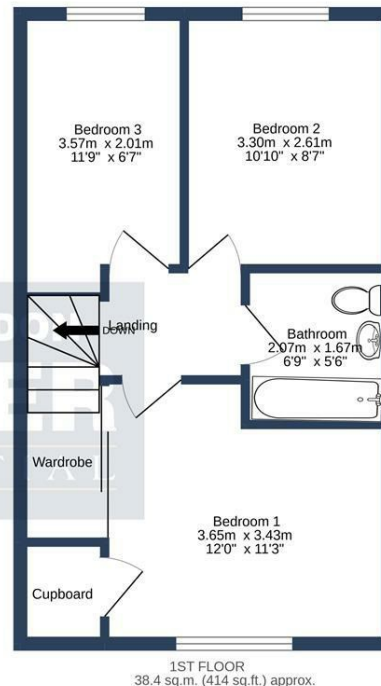
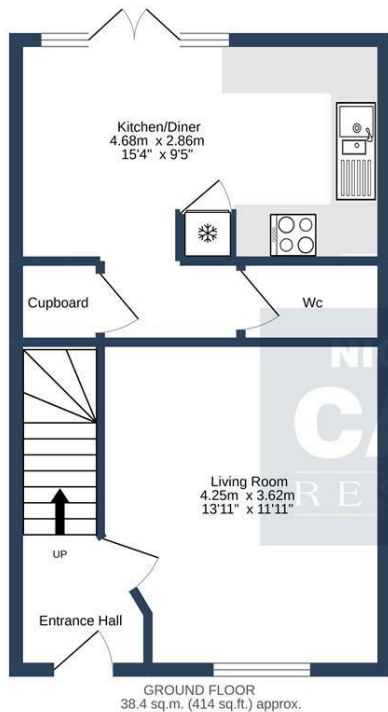

WOODLAND AVENUE, COLBURN, DL9 4WD.

TOTAL FLOOR AREA : 76.9 sq.m. (827 sq.ft.) approx.

Whilst every attempt has been made to ensure the accuracy of the floorplan contained here, measurements of doors, windows, rooms and any other items are approximate and no responsibility is taken for any error, omission or mis-statement. This plan is for illustrative purposes only and should be used as such by any prospective purchaser. The services, systems and appliances shown have not been tested and no guarantee as to their operability or efficiency can be given.  
Made with Metropix ©2022.

Energy Efficiency Rating		
	Current	Potential
Very energy efficient - lower running costs		
(92 plus) <b>A</b>		93
(81-91) <b>B</b>	82	
(69-80) <b>C</b>		
(55-68) <b>D</b>		
(39-54) <b>E</b>		
(21-38) <b>F</b>		
(1-20) <b>G</b>		
Not energy efficient - higher running costs		
<b>England &amp; Wales</b>		EU Directive 2002/91/EC

**We can search 1,000s of mortgages for you**

It could take just 15 minutes with one of our specialist advisers:  
Call: 01325 380088. Visit: Any of our Offices. Online: [www.mortgageadvicebureau.com/carver](http://www.mortgageadvicebureau.com/carver)



Your home may be repossessed if you do not keep up repayments on your mortgage.  
There will be a fee for mortgage advice. The actual amount you pay will depend upon your circumstances.  
The fee is up to 1% but a typical fee is 0.3% of the amount borrowed

MAB 6202



These particulars do not constitute any part of an offer or contract. None of the statements contained in these particulars are to be relied on as statements or representations of fact and any intending purchaser must satisfy himself by inspection or otherwise to the correctness of each of the statements contained in these particulars. The vendor does not make or give, and neither Nick & Gordon Carver Residential or Commercial, Nick & Gordon Carver, nor any person in their employment has any authority to make or give any representation or warranty whatever in relation to this property

**naea**  
**propertymark**  
**PROTECTED**

**14 Duke Street, Darlington**  
**County Durham, DL3 7AA**  
**Tel: 01325 357807**  
**[sales@carvergroup.co.uk](mailto:sales@carvergroup.co.uk)**

**26 Market Place, Richmond**  
**North Yorkshire, DL10 4QG**  
**Tel: 01748 825317**  
**[richmond@carvergroup.co.uk](mailto:richmond@carvergroup.co.uk)**

**43 Dalton Way, Newton Aycliffe**  
**County Durham, DL5 4DJ**  
**Tel: 01325 320676**  
**[aycliffe@carvergroup.co.uk](mailto:aycliffe@carvergroup.co.uk)**

**219 High Street, Northallerton**  
**North Yorkshire, DL7 8LW**  
**Tel: 01609 777710**  
**[northallerton@carvergroup.co.uk](mailto:northallerton@carvergroup.co.uk)**

**[www.carvergroup.co.uk](http://www.carvergroup.co.uk)**